



Laser class 2 in acc. to IEC 60825-1

www.disto.com



SAP. No. 788 219

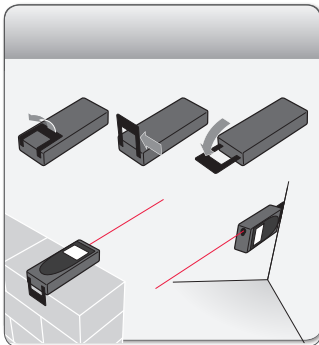

Keylock ON

 +  2 sec.



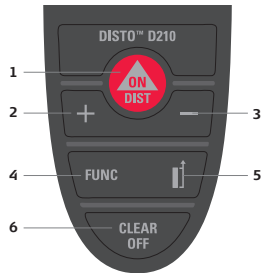

Quick Start

Leica DISTO™ D210



- 1 ON/DIST (on/measure)
- 2 Add
- 3 Subtract
- 4 Functions
- 5 Measuring reference
- 6 Clear/Off



 1x 

 2 sec. 

 permanent

Key Combinations

 +  2 sec.



 +  2 sec.



 +  2 sec.

 change units

Keylock OFF



< 2 sec.   

- when it has to be **right**

Leica
Geosystems



FUNC 1x

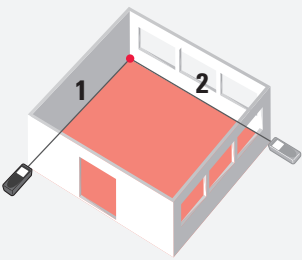

FUNC 3x



→ History (1-10)

+ 1 ... 10

- 10 ... 1

CLEAR OFF + FUNC 2 sec.

→ delete history

FUNC 5x

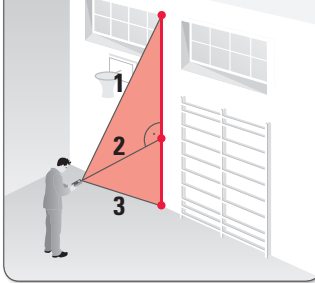

FUNC 2x

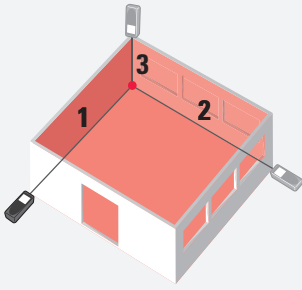

FUNC 4x

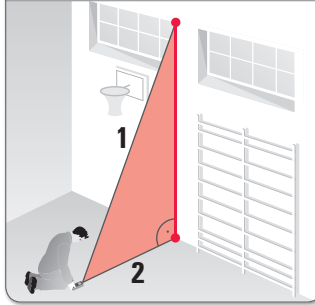

FUNC 6x

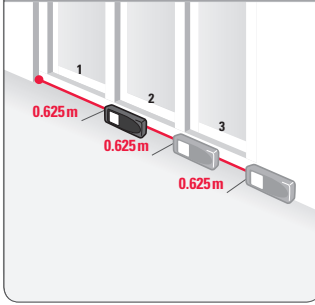

1x → ON
2 sec. → OFF

1x



2 sec.

